

EVOLVE SOAP DISPENSER

How to clean and disinfect



All Evans Vanodine hand washes contain a preservative to help prevent bacterial growth, however, it is still important to wash the dispenser reservoir, fittings and outlet valves each time the dispenser is refilled, when a new cartridge is required or when the dispenser has been dormant for a period of time, such as school holidays.



Prior to any task wash your hands for 20 seconds then rinse and dry thoroughly.



Prepare a solution of Evans Chlor Tabs, 1 tablet per 1 litre of warm water.

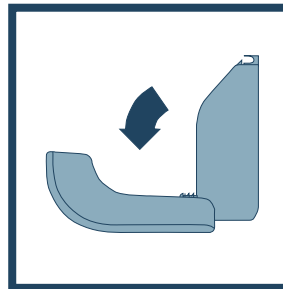

Open dispenser either by using a key or by push down and pull method.

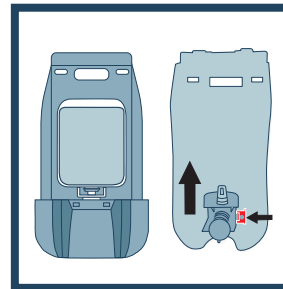

Cartridge dispenser: Remove empty cartridge and recycle. Press release fitting to remove the valve.

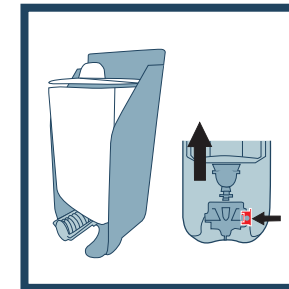

Bulk fill dispenser: Press the release fitting to remove the connected reservoir and valve.



Rinse valve and reservoir in warm water, until no foam is produced.



To disinfect soak valve and reservoir in the Chlor Tabs solution - up to 15 minutes.



Rinse with clean water, wipe with disposable cloth or paper towel. Allow to air dry.

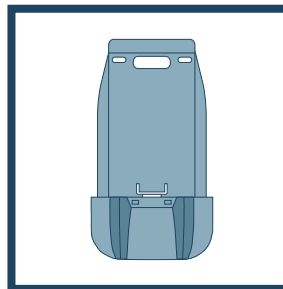

Wipe interior and exterior of the dispenser with clean warm water and a clean cloth.

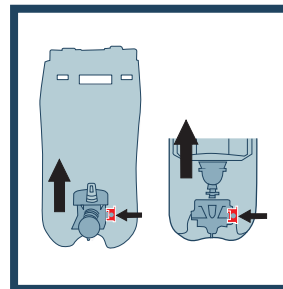

Press the release fitting and replace the valve and reservoir.

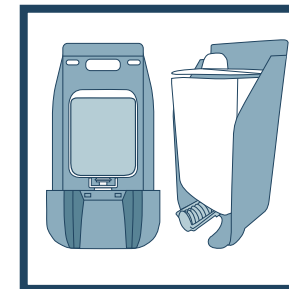

Fit a new cartridge or fill the reservoir with hand wash, replace top of reservoir.

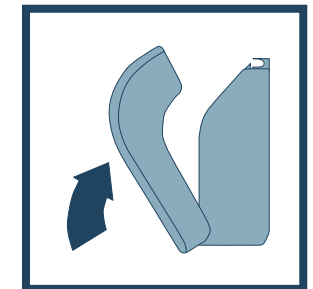

Close front cover until it clicks into locked position.

Biofilms can form on the inside of refillable reservoirs, outlet valves and fittings if they are not cleaned regularly. Bacteria and mould can multiply in the biofilm and may contaminate soap. Regular cleaning and disinfection will help to prevent this.

Washing hands in the correct way and drying them thoroughly is the single most effective way to prevent the spread of coughs, colds and other infections, including Norovirus. Good quality hand washing facilities in your washroom are an effective way to encourage people to use them to help prevent and control infection.